

**A** TYPICAL CONCRETE HOUSEKEEPING PAD DETAIL  
 S2.1 | S4.1 1:10  
 • COORDINATE EXACT QUANTITY, LOCATIONS AND DIMENSIONS REQUIRED WITH ELECTRICAL AND MECHANICAL.

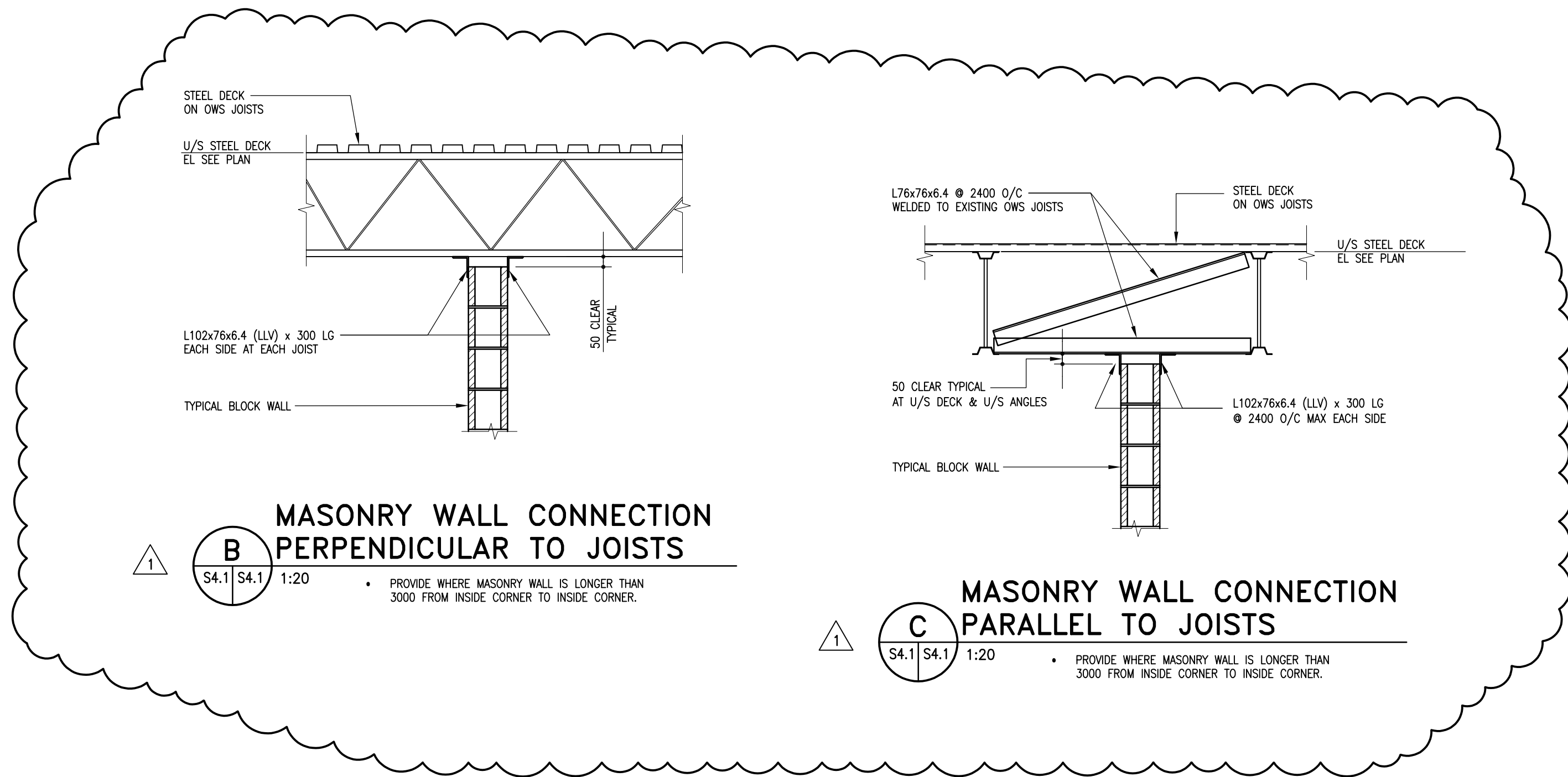

**B** MASONRY WALL CONNECTION PERPENDICULAR TO JOISTS  
 S4.1 | S4.1 1:20  
 • PROVIDE WHERE MASONRY WALL IS LONGER THAN 3000 FROM INSIDE CORNER TO INSIDE CORNER.

**C** MASONRY WALL CONNECTION PARALLEL TO JOISTS  
 S4.1 | S4.1 1:20  
 • PROVIDE WHERE MASONRY WALL IS LONGER THAN 3000 FROM INSIDE CORNER TO INSIDE CORNER.

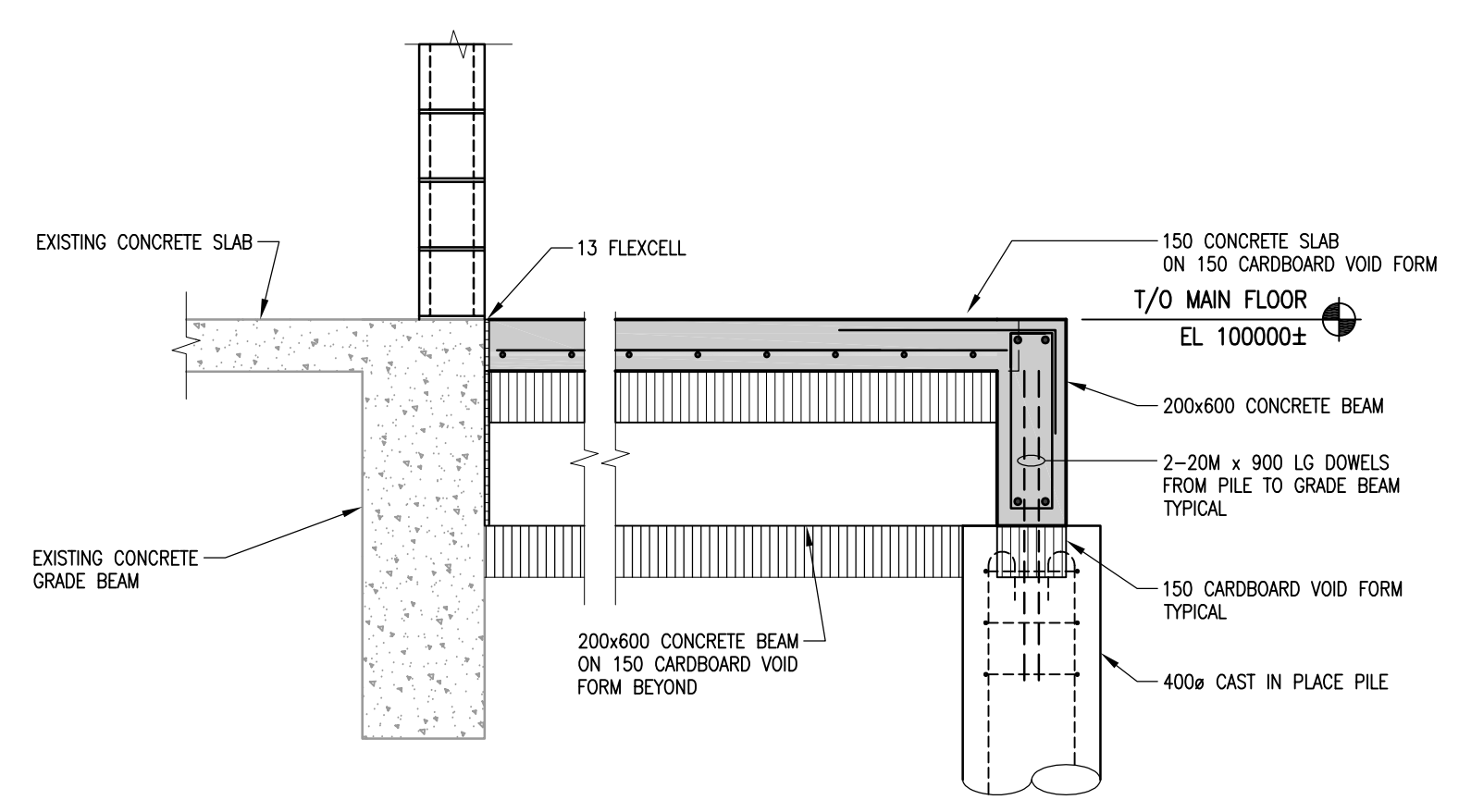

**1** SECTION  
 S2.1 | S4.1 1:20

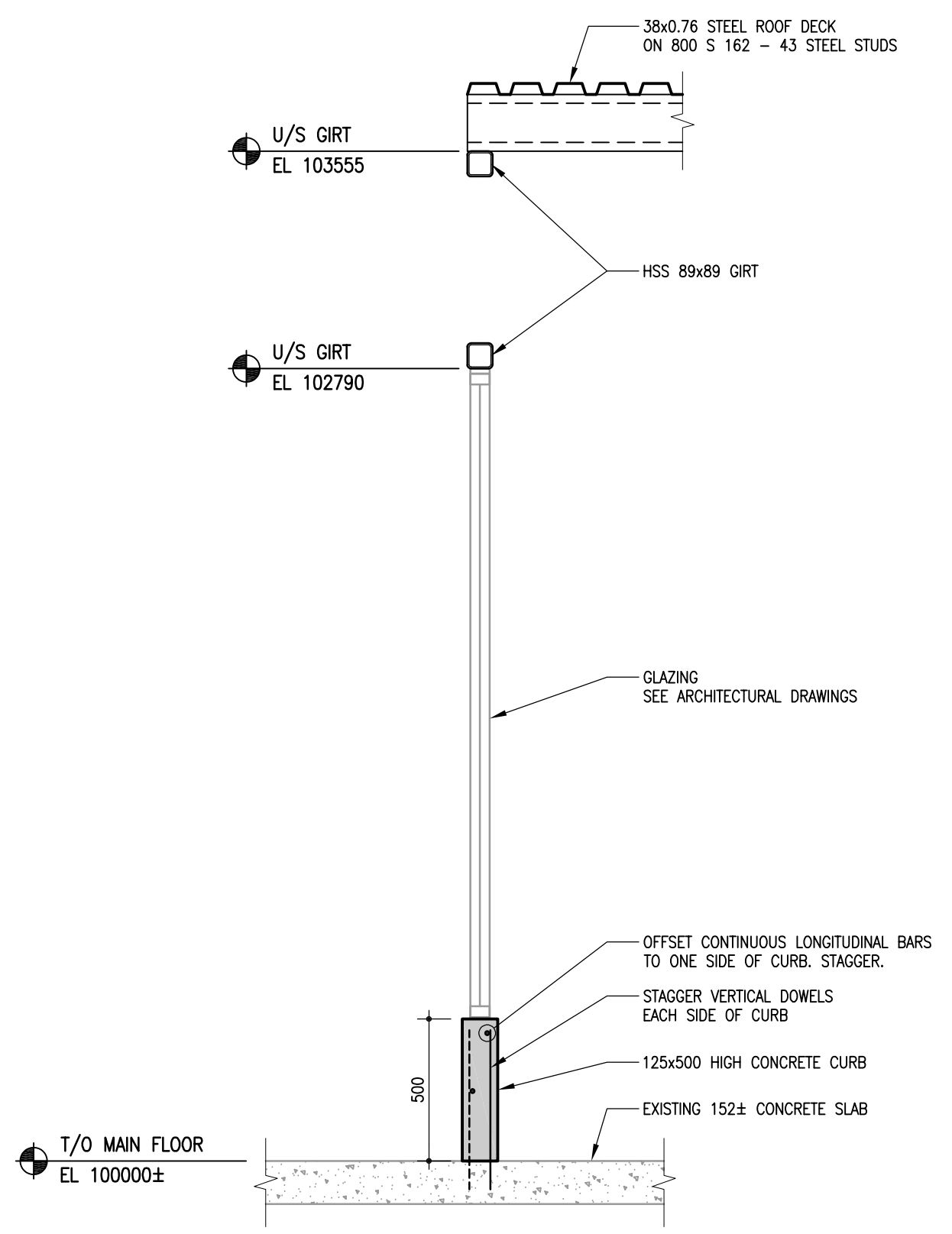

**2** SECTION  
 S2.1 | S4.1 1:20

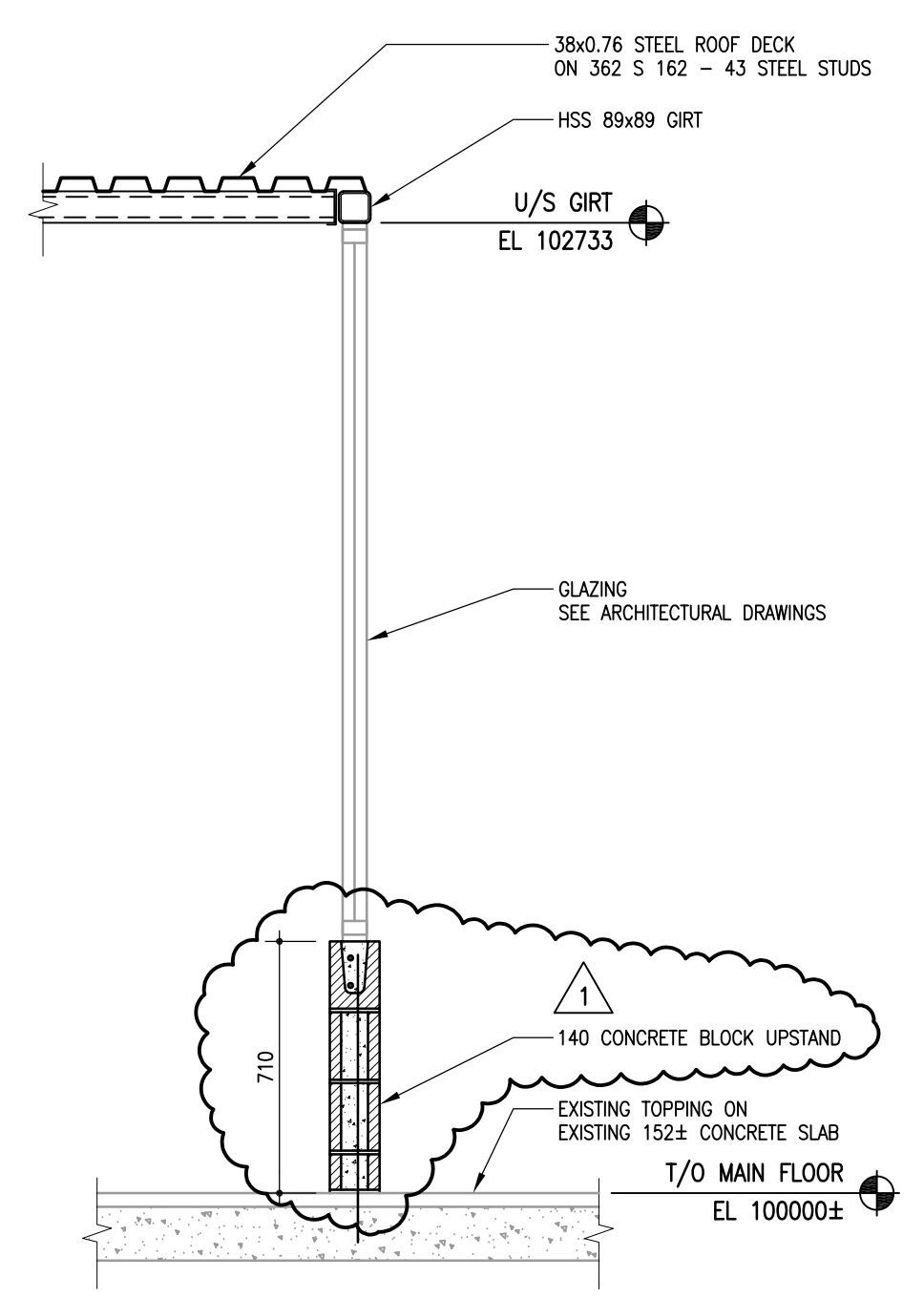

**3** SECTION  
 S2.1 | S4.1 1:20

No.	Date	Issue / Revision	By
1	2022-07-14	ISSUED FOR ADDENDUM #6	TWS
0	2022-06-21	ISSUED FOR CONSTRUCTION	BF

Drawn By: CJM  
 Printing Date:

Drawings and specifications, as instruments of service are the property of the architects, their copyright in the same being reserved to them. No reproduction may be made without the permission of the architects, and when made, must bear their names. All prints to be returned.  
 The contractor is to verify dimensions and data noted herein with conditions on the site and is held responsible for reporting any discrepancy to the architects for adjustment.

**LM Architectural Group**  
 500-136 Market Ave  
 Winnipeg, Manitoba, Canada R3B 0P4  
 T: (204) 942-0681 F: (204) 943-8676  
 www.lm-architects.com

**CITY OF WINNIPEG  
 BONIVITAL POOL RENEWAL**

1215 ARCHIBALD ST, WINNIPEG, MB.

**SECTIONS**